

PARK RIDGE

DUBAI HILLS
ESTATE



EMAAR



MERAAS



WHERE URBAN LIVING
AND NATURE UNITE

1, 2 and 3 bedroom apartments
Equipped with modern amenities
Adjacent to Central Park & Boulevard



TAKE A STROLL THROUGH THE
SCENIC CENTRAL PARK AND
ENJOY THE OUTDOORS

Children's Play Areas, Outdoor Gymnasium
2 Kilometre Jogging Track, Art Installations
Fountains, Water Features and Splash Pad



EXPLORE A RANGE OF RETAIL OUTLETS,
CAFÉS, RESTAURANTS AND RECREATIONAL
FACILITIES ON THE BOULEVARD

- Popular Cafés and Restaurants
- A Variety of Retail Stores and Recreation Facilities
- Art Studios and Installations



VISIT DUBAI HILLS ESTATE MALL FEATURING
HIGH STREET FASHION BRANDS, DINING
OPTIONS AND ENTERTAINMENT VENUES

Cutting-edge Cinemas, Family Entertainment Venues
Linked Directly to Future Metro Lines
Leading Fashion and Retail Outlets

DUBAI HILLS MALL











AMENITIES

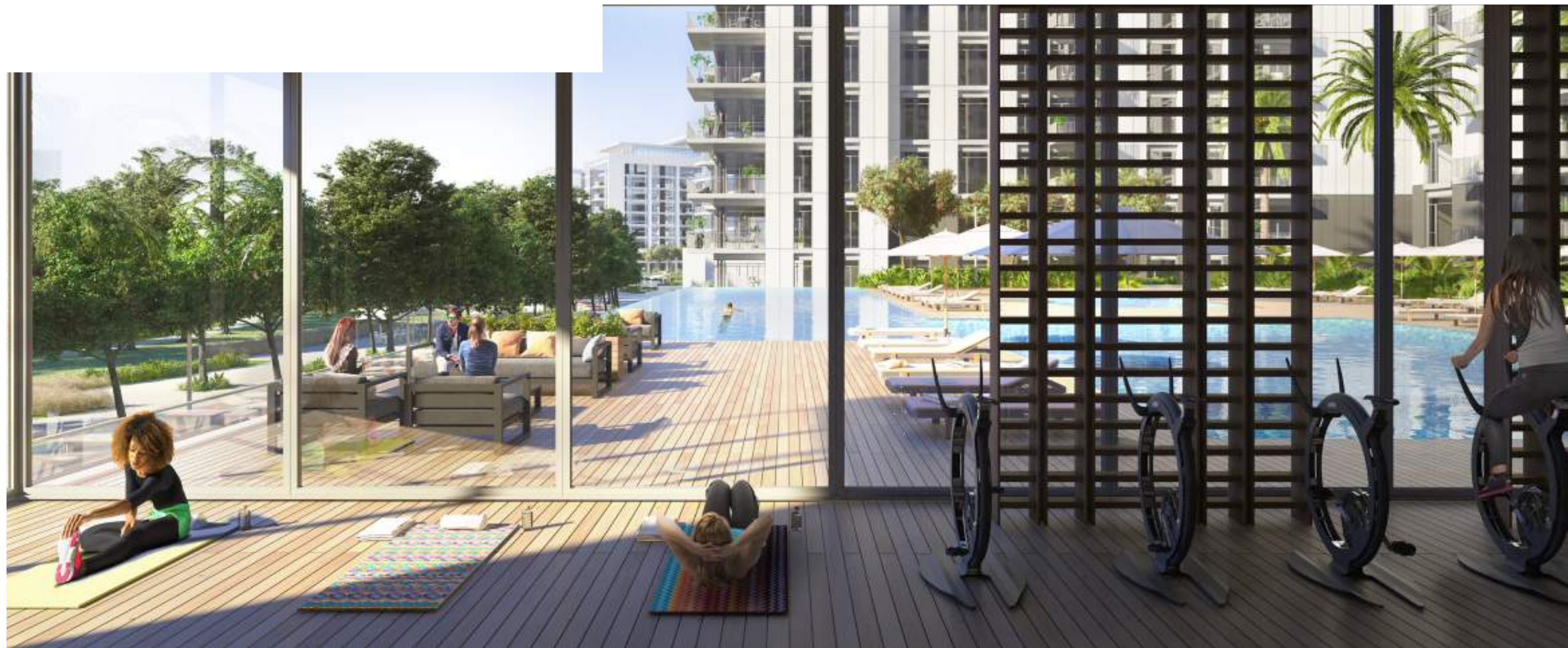

DUBAI HILLS ESTATE

DUBAI MARINA
THE DUBAI MALL
BURJ KHALIFA

10
MINUTES

JUMEIRAH
BEACH

12
MINUTES

DUBAI CREEK
TOWER

15
MINUTES

DUBAI INTL
AIRPORT

20
MINUTES

AL MAKTUUM
AIRPORT

35
MINUTES

All Distances are Approximate

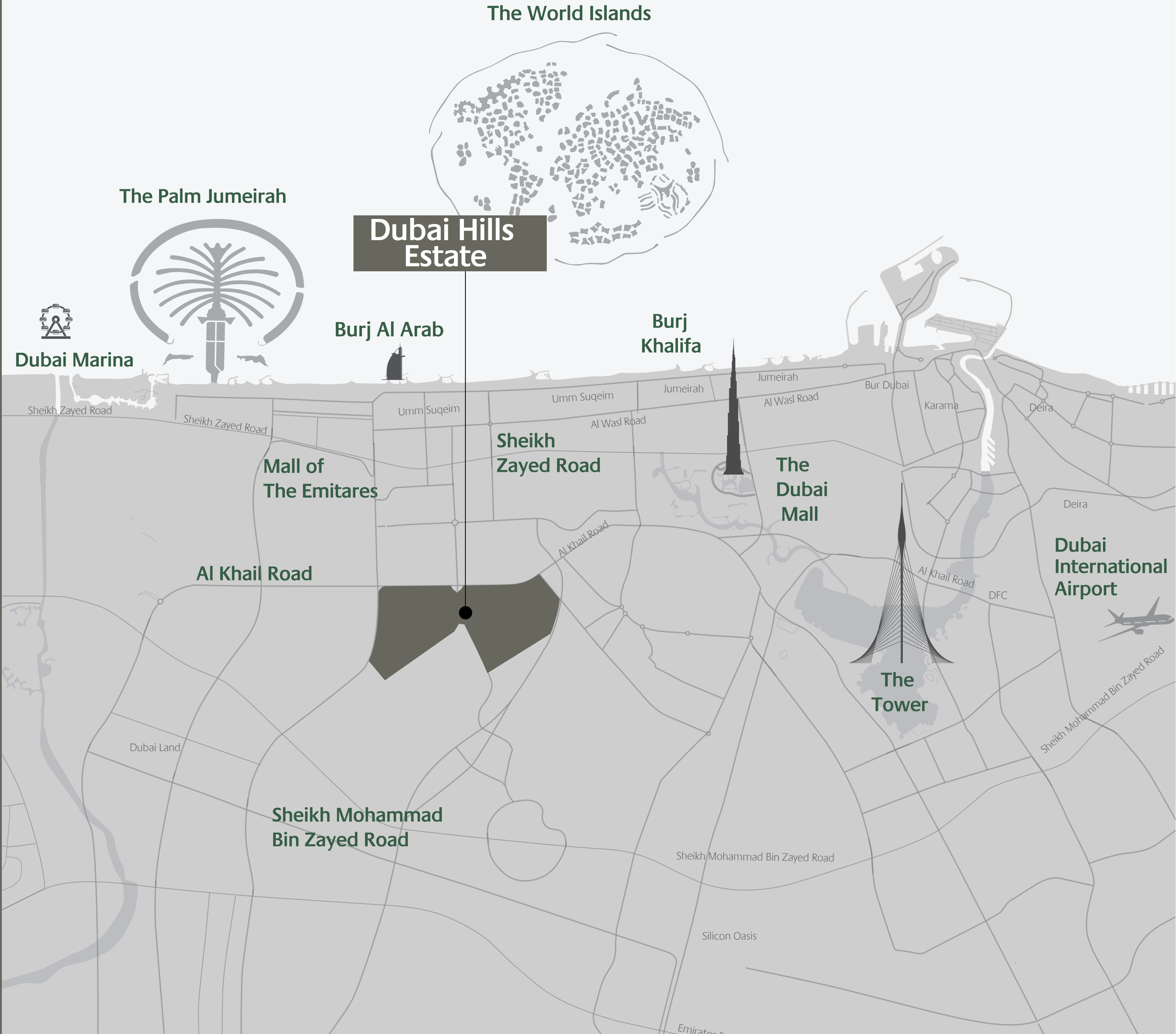

DUBAI HILLS

ESTATE



32,000
RESIDENTIAL UNITS



282,000 SQM
REGIONAL MALL



132,000
RESIDENTS



3
SCHOOLS



1,100 KEYS
3 HOTELS



1.45 MILLION
SQM
PARKS & OPEN SPACES



54
KILOMETERS
BICYCLE ROUTES



1.120 M SQM
18 HOLE GOLF COURSE



2
HOSPITALS

DUBAI HILLS
ESTATE

PARK RIDGE

TOWER C & TOWNHOUSES

FLOOR PLANS



EMAAR



MERAAS

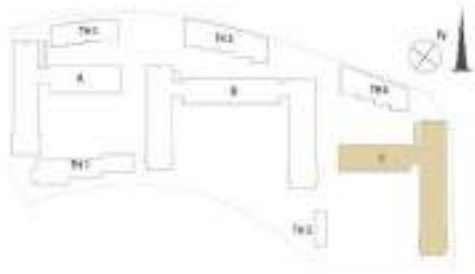

| 1 BEDROOM - 1A & 1B | |
|---|--------------------------------|
| TOWER C | |
| LEVELS | UNITS |
| GF | 01, 02, 03, 04, 05, 09, 10, 18 |
| UNIT AREA | |
| 56.41 ^{Sq.m} / 607.19 ^{Sq.ft} | |
| GARDEN AREA | |
| 24.75 ^{Sq.m} / 266.41 ^{Sq.ft} | |
| TOTAL AREA | |
| 81.16 ^{Sq.m} / 873.60 ^{Sq.ft} | |

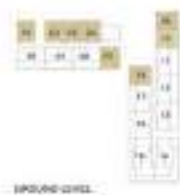

GROUND LEVEL



LEVEL 02



LEVEL 03



LEVEL 04



LEVEL 05



LEVEL 09



LEVEL 10



LEVEL 18



LEVEL 19-01



LEVEL 19-02



LEVEL 18

FLOOR PLAN 1. All dimensions are in imperial and metric, and measured from finish to finish excluding construction tolerances. 2. All materials, dimensions, and drawings are approximate only. 3. Information is subject to change without notice, at developer's absolute discretion. 4. Actual area may vary from the stated area. 5. Drawings not to scale. 6. All images used are for illustrative purposes only and do not represent the actual size, features, specifications, fittings, and furnishings. 7. The developer reserves the right to make revisions / alterations, at its absolute discretion, without any liability whatsoever.

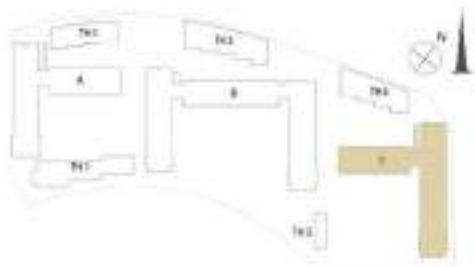

| 1 BEDROOM - 1C | |
|--|------------------------|
| TOWER C | |
| LEVELS | UNITS |
| 01 | 03, 04, 06, 12, 13, 21 |
| 02-07 | 03, 04, 06, 12, 13, 21 |
| 08 | 03, 04, 06, 12, 13, 21 |
| 09 | 03, 04, 06, 12, 13, 21 |
| 10 | 03, 04, 06, 12, 13, 21 |
| 11 | 03, 04, 06, 12, 13, 21 |
| 12 | 03, 04, 06, 12, 13, 21 |
| 13-18 | 03, 04, 06, 12, 13, 21 |
| 19-21 | 03, 04, 06, 12, 13, 21 |
| 22 | 03, 04, 12 |
| UNIT AREA 56.55 ^{sqm} / 608.70 ^{sq ft} | |
| BALCONY AREA 3.99 ^{sqm} / 42.95 ^{sq ft} | |
| TOTAL AREA 60.54 ^{sqm} / 651.65 ^{sq ft} | |

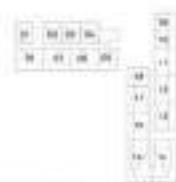

LEVEL 01



LEVEL 02



LEVEL 03



LEVEL 04



LEVEL 05



LEVEL 06



LEVEL 07



LEVEL 08



LEVEL 09



LEVEL 10



LEVEL 11

FLOOR PLAN 1. All dimensions are in imperial and metric, and measured from finish to finish excluding construction tolerances. 2. All materials, dimensions, and drawings are approximate only. 3. Information is subject to change without notice, at developer's absolute discretion. 4. Actual area may vary from the stated area. 5. Drawings not to scale. 6. All images used are for illustrative purposes only and do not represent the actual size, features, specifications, fittings, and furnishings. 7. The developer reserves the right to make revisions/alterations, at its absolute discretion, without any liability whatsoever.

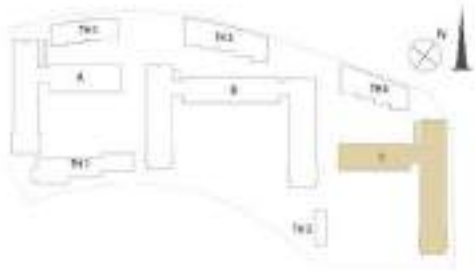

| 1 BEDROOM - 1D | |
|---|----------------|
| TOWER C | |
| LEVELS | UNITS |
| 01 | 01, 02, 05, 11 |
| 02-07 | 01, 02, 05, 11 |
| 08 | 01, 02, 05, 11 |
| 09 | 01, 02, 05, 11 |
| 10 | 01, 02, 05, 11 |
| 11 | 01, 02, 05, 11 |
| 12 | 01, 02, 05, 11 |
| 13-18 | 01, 02, 05, 11 |
| 19-21 | 01, 02, 05, 11 |
| 22 | 02 |
| UNIT AREA | |
| 56.31 ^{Sq.m} / 606.12 ^{Sq.ft} | |
| BALCONY AREA | |
| 3.99 ^{Sq.m} / 42.95 ^{Sq.ft} | |
| TOTAL AREA | |
| 60.30 ^{Sq.m} / 649.07 ^{Sq.ft} | |



LEVEL 01



LEVEL 02



LEVEL 03



LEVEL 04



LEVEL 05



LEVEL 06



LEVEL 07



LEVEL 08



LEVEL 09



LEVEL 10



LEVEL 11

FLOOR PLAN 1. All dimensions are in imperial and metric, and measured from finish to finish excluding construction tolerances. 2. All materials, dimensions, and drawings are approximate only. 3. Information is subject to change without notice, at developer's absolute discretion. 4. Actual area may vary from the stated area. 5. Drawings not to scale. 6. All images used are for illustrative purposes only and do not represent the actual size, features, specifications, fittings, and furnishings. 7. The developer reserves the right to make revisions / alterations, at its absolute discretion, without any liability whatsoever.

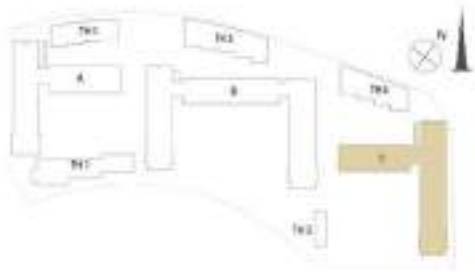

| 1 BEDROOM - 1B | |
|---|-------|
| TOWER C | |
| LEVELS | UNITS |
| 19-21 | 17 |
| 22 | 08 |
| UNIT AREA | |
| 57.04 ^{sqm} / 613.97 ^{sqft} | |
| BALCONY AREA | |
| 2.92 ^{sqm} / 31.43 ^{sqft} | |
| TOTAL AREA | |
| 59.96 ^{sqm} / 645.40 ^{sqft} | |

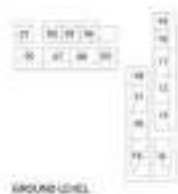

GROUND LEVEL



LEVEL 01



LEVEL 007



LEVEL 08



LEVEL 09



LEVEL 10



LEVEL 11



LEVEL 12



LEVEL 14



LEVEL 17



LEVEL 22

FLOOR PLAN 1. All dimensions are in imperial and metric, and measured from finish to finish excluding construction tolerances. 2. All materials, dimensions, and drawings are approximate only. 3. Information is subject to change without notice, at developer's absolute discretion. 4. Actual area may vary from the stated area. 5. Drawings not to scale. 6. All images used are for illustrative purposes only and do not represent the actual size, features, specifications, fittings, and furnishings. 7. The developer reserves the right to make revisions/alterations, at its absolute discretion, without any liability whatsoever.

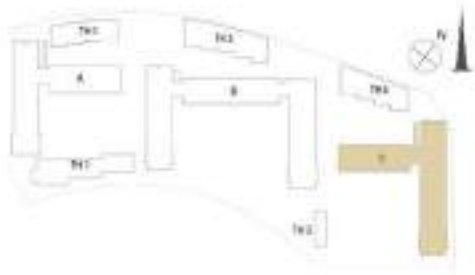

| 2 BEDROOM - 2A | |
|--|--------------------------------|
| TOWER C | |
| LEVELS | UNITS |
| GF | 06, 07, 08, 11, 12, 13, 16, 17 |
| UNIT AREA | |
| 87.54 ^{Sq.m} / 942.27 ^{Sq.ft.} | |
| GARDEN AREA | |
| 39.22 ^{Sq.m} / 422.16 ^{Sq.ft.} | |
| TOTAL AREA | |
| 126.76 ^{Sq.m} / 1364.43 ^{Sq.ft.} | |

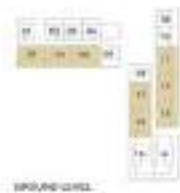

LEVEL 06



LEVEL 07



LEVEL 08



LEVEL 11



LEVEL 12



LEVEL 13



LEVEL 16



LEVEL 17



LEVEL 16A



LEVEL 16B



LEVEL 17A

FLOOR PLAN 1. All dimensions are in imperial and metric, and measured from finish to finish excluding construction tolerances. 2. All materials, dimensions, and drawings are approximate only. 3. Information is subject to change without notice, at developer's absolute discretion. 4. Actual area may vary from the stated area. 5. Drawings not to scale. 6. All images used are for illustrative purposes only and do not represent the actual size, features, specifications, fittings, and furnishings. 7. The developer reserves the right to make revisions/alterations, at its absolute discretion, without any liability whatsoever.

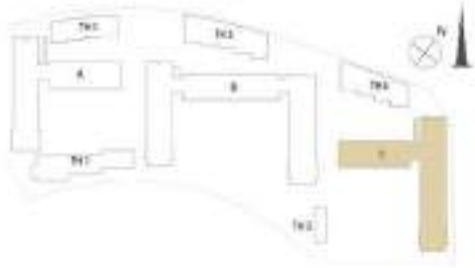

| 2 BEDROOM - 2C | |
|---|------------------------------------|
| TOWER C | |
| LEVELS | UNITS |
| 01 | 07, 08, 09, 10, 14, 15, 16, 19, 20 |
| 02-07 | 07, 08, 09, 10, 14, 15, 16, 19, 20 |
| 08 | 07, 08, 09, 10, 14, 15, 16, 19, 20 |
| 09 | 07, 08, 09, 10, 14, 15, 16, 19, 20 |
| 10 | 07, 08, 09, 10, 14, 15, 16, 19, 20 |
| 11 | 07, 08, 09, 10, 14, 15, 16, 19, 20 |
| 12 | 07, 08, 09, 10, 14, 15, 16, 19, 20 |
| 13-18 | 07, 08, 09, 10, 14, 15, 16, 19, 20 |
| 19-21 | 07, 08, 09, 10, 14, 15, 16, 19, 20 |
| 22 | 01, 05, 06, 07, 10, 11 |
| UNIT AREA | |
| 87.60 ^{Sqm} / 942.92 ^{Sq.ft.} | |
| BALCONY AREA | |
| 5.18 ^{Sqm} / 55.76 ^{Sq.ft.} | |
| TOTAL AREA | |
| 92.78 ^{Sqm} / 998.68 ^{Sq.ft.} | |

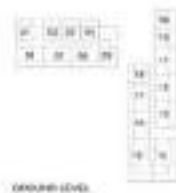

LEVEL 01



LEVEL 02



LEVEL 08



LEVEL 09



LEVEL 10



LEVEL 11



LEVEL 12



LEVEL 13



LEVEL 19



LEVEL 22



LEVEL 22

FLOOR PLAN 1. All dimensions are in imperial and metric, and measured from finish to finish excluding construction tolerances. 2. All materials, dimensions, and drawings are approximate only. 3. Information is subject to change without notice, at developer's absolute discretion. 4. Actual area may vary from the stated area. 5. Drawings not to scale. 6. All images used are for illustrative purposes only and do not represent the actual size, features, specifications, fittings, and furnishings. 7. The developer reserves the right to make revisions/alterations, at its absolute discretion, without any liability whatsoever.

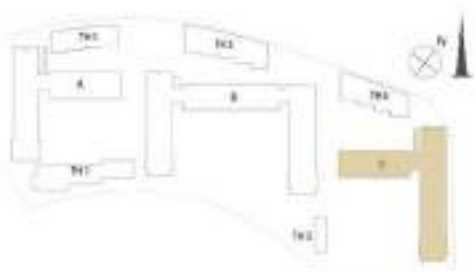

| 3 BEDROOM - 3A | |
|---|--------|
| TOWER C | |
| LEVELS | UNITS |
| GF | 14, 15 |
| UNIT AREA | |
| 130.79 ^{Sq.m.} / 1407.81 ^{Sq.ft.} | |
| GARDEN AREA | |
| 76.97 ^{Sq.m.} / 828.50 ^{Sq.ft.} | |
| TOTAL AREA | |
| 207.76 ^{Sq.m.} / 2236.31 ^{Sq.ft.} | |

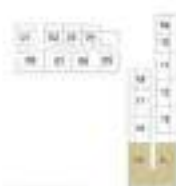

LEVEL 04



LEVEL 05



LEVEL 06



LEVEL 07



LEVEL 08



LEVEL 09



LEVEL 10



LEVEL 11



LEVEL 12



LEVEL 13



LEVEL 14

FLOOR PLAN 1. All dimensions are in imperial and metric, and measured from finish to finish excluding construction tolerances. 2. All materials, dimensions, and drawings are approximate only. 3. Information is subject to change without notice, at developer's absolute discretion. 4. Actual area may vary from the stated area. 5. Drawings not to scale. 6. All images used are for illustrative purposes only and do not represent the actual size, features, specifications, fittings, and furnishings. 7. The developer reserves the right to make revisions / alterations, at its absolute discretion, without any liability whatsoever.

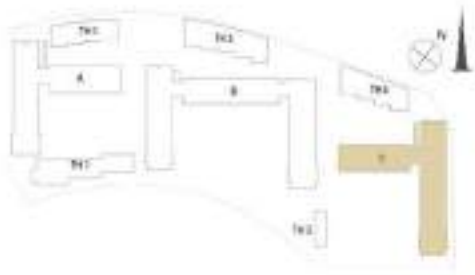

| 3 BEDROOM - 3B | |
|--|--------|
| TOWER C | |
| LEVELS | UNITS |
| 01 | 17, 18 |
| 02-07 | 17, 18 |
| 08 | 17, 18 |
| 09 | 17, 18 |
| 10 | 17, 18 |
| 11 | 17, 18 |
| 12 | 17, 18 |
| 13-18 | 17, 18 |
| UNIT AREA | |
| 130.79 ^{sqm} / 1407.81 ^{sq ft} | |
| BALCONY AREA | |
| 16.72 ^{sqm} / 179.97 ^{sq ft} | |
| TOTAL AREA | |
| 147.51 ^{sqm} / 1587.78 ^{sq ft} | |

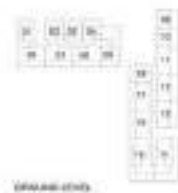

LEVEL 01



LEVEL 02



LEVEL 03



LEVEL 04



LEVEL 05



LEVEL 06



LEVEL 07



LEVEL 08



LEVEL 09



LEVEL 10



LEVEL 11

FLOOR PLAN 1. All dimensions are in imperial and metric, and measured from finish to finish excluding construction tolerances. 2. All materials, dimensions, and drawings are approximate only. 3. Information is subject to change without notice, at developer's absolute discretion. 4. Actual area may vary from the stated area. 5. Drawings not to scale. 6. All images used are for illustrative purposes only and do not represent the actual size, features, specifications, fittings, and furnishings. 7. The developer reserves the right to make revisions/alterations, at its absolute discretion, without any liability whatsoever.

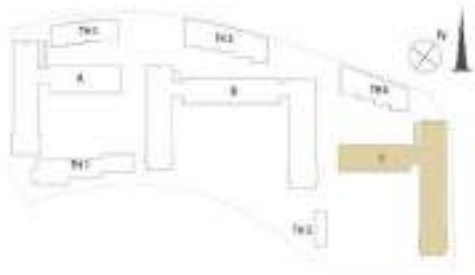

| 3 BEDROOM - 3D | |
|---|-------|
| TOWER C | |
| LEVELS | UNITS |
| 19-21 | 18 |
| 22 | 09 |
| UNIT AREA | |
| 140.15 ^{Sq.m.} / 1508.56 ^{Sq.ft.} | |
| BALCONY AREA | |
| 95.38 ^{Sq.ft.} / 1026.66 ^{Sq.ft.} | |
| TOTAL AREA | |
| 235.53 ^{Sq.m.} / 2535.22 ^{Sq.ft.} | |

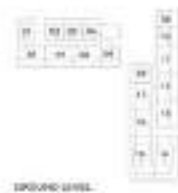

LEVEL 01



LEVEL 02



LEVEL 03



LEVEL 04



LEVEL 05



LEVEL 06



LEVEL 07



LEVEL 08



LEVEL 09



LEVEL 10



LEVEL 11

FLOOR PLAN 1. All dimensions are in imperial and metric, and measured from finish to finish excluding construction tolerances. 2. All materials, dimensions, and drawings are approximate only. 3. Information is subject to change without notice, at developer's absolute discretion. 4. Actual area may vary from the stated area. 5. Drawings not to scale. 6. All images used are for illustrative purposes only and do not represent the actual size, features, specifications, fittings, and furnishings. 7. The developer reserves the right to make revisions/alterations, at its absolute discretion, without any liability whatsoever.

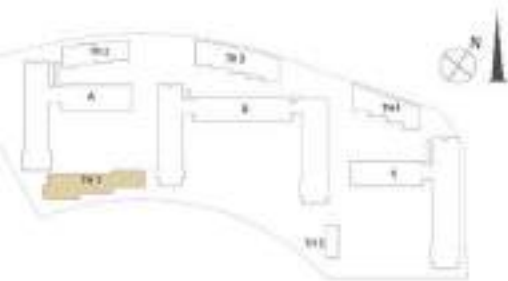

| PODIUM TOWNHOUSES - TYPE A | |
|--|------------------------------------|
| LEVELS | UNITS |
| | TH01, TH02, TH03, TH04, TH05, TH06 |
| UNIT AREA | |
| 145.77 ^{sq.m} / 1569.06 ^{sq.ft.} | |
| GARDEN AREA | |
| 92.45 ^{sq.m} / 995.12 ^{sq.ft.} | |
| TOTAL AREA | |
| 238.22 ^{sq.m} / 2564.18 ^{sq.ft.} | |

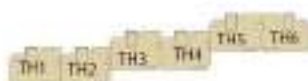



| PODIUM TOWNHOUSES-TYPE B | |
|--------------------------|--|
| LEVELS | UNITS |
| | TH07, TH08, TH09, TH10, TH11, TH12, TH13, TH14, TH15 |
| UNIT AREA | |
| | 160.64 ^{Sq.m.} / 1729.11 ^{Sq.ft.} |
| GARDEN AREA | |
| | 90.80 ^{Sq.m.} / 977.36 ^{Sq.ft.} |
| TOTAL AREA | |
| | 251.44 ^{Sq.m.} / 2706.47 ^{Sq.ft.} |

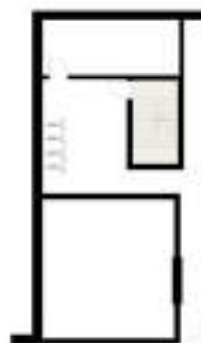

BASEMENT 01



GROUND LEVEL



LEVEL 01





| PODIUM TOWNHOUSES - TYPE C | |
|--|------------------------|
| LEVELS | UNITS |
| | TH16, TH17, TH18, TH19 |
| UNIT AREA | |
| 160.74 ^{Sq.m} / 1730.19 ^{Sq.ft.} | |
| GARDEN AREA | |
| 93.78 ^{Sq.m} / 1009.44 ^{Sq.ft.} | |
| TOTAL AREA | |
| 254.52 ^{Sq.m} / 2739.63 ^{Sq.ft.} | |



BASEMENT 01



GROUND LEVEL



LEVEL 01





| PODIUM TOWNHOUSES -TYPE D | |
|---------------------------|--|
| LEVELS | UNITS |
| | TH20, TH21 |
| UNIT AREA | |
| | 160.74 ^{Sq.m} / 1730.19 ^{Sq.ft.} |
| GARDEN AREA | |
| | 24.53 ^{Sq.m} / 264.04 ^{Sq.ft.} |
| TOTAL AREA | |
| | 185.59 ^{Sq.m} / 1997.68 ^{Sq.ft.} |



GROUND LEVEL



LEVEL 01

DUBAI HILLS ESTATE

PARK RIDGE

For more information on **Park Ridge** at **Dubai Hills Estate**, please call 800 36227(UAE) or +971 4 366 1688 (International). Visit our online sales centre at emaar.com or any of our sales centres across the UAE.

DUBAI

Dubai Hills Estate Sales Pavillion: Umm Suqeim Road
Emaar Sales Center: Downtown Dubai
Dubai Creek Harbour Sales Centre: Ras Al Khor

ABU DHABI

Emaar Sales Centre: Al Nahda Tower, Ground Floor, 4th Street, Corniche, Al Muroor Road

Open from Saturday - Thursday, from 8.30am - 6pm

 **EMAAR** |  **MERAAS**

دبي هيلز استيت

بارك ريدج

للمزيد من المعلومات حول بارك ريدج في دبي هيلز استيت، الرجاء الاتصال بالرقم (٨٠٠٣٦٢٢٧) في الإمارات العربية المتحدة أو +٩٧١ ٤ ٣٦٦ ١٦٨٨ (دولي) أو قم بزيارة مركز مبيعاتنا الإلكتروني على الموقع emaar.com

دبي

مركز مبيعات دبي هيلز استيت على طريق أم سقيم
مركز مبيعات إعمار في وسط مدينة دبي
مركز مبيعات خور دبي في رأس الخور

أبوظبي

مركز مبيعات إعمار في برج النهضة، الشارع الرابع،
الكورنيش، طريق المرور - أبوظبي

السبت إلى الخميس من الساعة ٨:٣٠ صباحاً حتى الساعة ٦ مساءً

 **إعمار** |  **إعمار**